

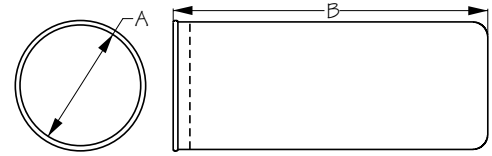

DECK PLATE BAG

Nylon/Stainless Steel Ring



Bulk	Display	A	B	Wt.(lb.)	Std. Pack
n/a	337149R-1	4"	10"	.12	10 ea
n/a	337159R-1	5"	10"	.14	10 ea
n/a	337169R-1	6"	10"	.16	10 ea
n/a	337189R-1	8"	12"	.18	10 ea

Great for keeping your valuables dry while paddling. Fits all Sea-Dog® Deck Plates with Internal Collar. High visibility red color.



SAE POWER CABLE

Injection Molded PVC



Bulk	Display	A (Length)	Volts	Max Amps	Wire Gauge	Wt.(lb.)	Std. Pack
n/a	426901-1	12"	12-24	20A @ 12V	14 AWM	.11	10 ea
n/a	426903-1	36"	12-24	20A @ 12V	14 AWM	.17	10 ea
n/a	426906-1	72"	12-24	20A @ 12V	14 AWM	.26	5 ea
n/a	426912-1	144"	12-24	20A @ 12V	14 AWM	.44	5 ea

SAE type Polarized Electrical Connector is a two-prong plug and socket connector set. 14-gauge duplex wire. Maximum: 20A @ 12VDC.

⚠WARNING: Cancer and Reproductive Harm - www.P65Warnings.ca.gov



SAE POWER CABLE Y-SPLITTER

Injection Molded PVC

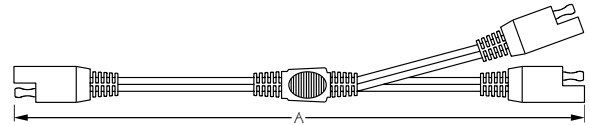

Bulk	Display	A (Length)	Volts	Max Amps	Wire Gauge	Wt.(lb.)	Std. Pack
n/a	426920-1	12"	12-24	20A @ 12V	14 AWM	.15	10 ea

SAE type Polarized Electrical Connector is a two-prong plug and socket Y-splitter connector set. 14-gauge duplex wire. Maximum: 20A @ 12VDC.

⚠WARNING: Cancer and Reproductive Harm - www.P65Warnings.ca.gov



SAE POWER CABLE ATO/ATC INLINE FUSE HOLDER

Injection Molded PVC

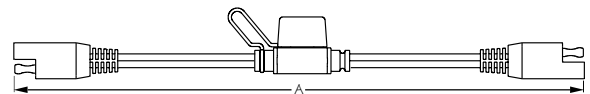

Bulk	Display	A (Length)	Volts	Max Amps	Wire Gauge	Wt.(lb.)	Std. Pack
n/a	426925-1	12"	12-24	20A @ 12V	14 AWM	.15	10 ea

SAE type Polarized Electrical Connector is a two-prong plug and socket connector set. Features an ATO/ATC inline fuse holder (fuse not included). 14-gauge duplex wire. Maximum: 20A @ 12VDC.

⚠WARNING: Cancer and Reproductive Harm - www.P65Warnings.ca.gov



SAE POWER CABLE POWER PLUG KIT

Injection Molded PVC

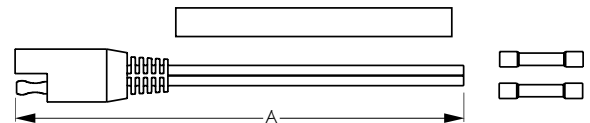

Bulk	Display	A (Length)	Volts	Max Amps	Wire Gauge	Wt.(lb.)	Std. Pack
n/a	426930-1	6"	12-24	20A @ 12V	14 AWM	.08	10 ea

SAE type Polarized Electrical Plug Kit is a two-prong plug and socket connector set. 14-gauge lead wire with bullet-type contact pins. Includes two plugs, four heat shrink tubes, and four butt connectors allowing you to customize your set per application. Maximum: 20A @ 12VDC.

⚠WARNING: Cancer and Reproductive Harm - www.P65Warnings.ca.gov