

FRED™

LED HEADLAMP

Operating and Maintenance
Instructions
Notice d'utilisation et d'entretien
Bedienungsanleitung



ENGLISH:

Battery Installation – See Battery Installation Diagram

- 3 AAA
- Alkaline (LR03) or Lithium
- Rechargeable NiCad or NiMH

Princeton Tec cares about the environment and recommends recycling batteries. For more information about battery recycling, please go to: www.batteryrecycling.com
Open the Fuel case by popping the door latch over the catch and rotate the door open.

Install three AAA batteries according to the polarity markings on the inside of the cabinet. Observe proper battery polarity when installing the batteries. Improper installation of the batteries will damage the light and void the warranty.

Rotate the door to the closed position, squeeze the body between your forefingers and thumb to Fred the door latch over the catch.

WARNING ⚠

- Never mix fresh and used batteries.
 - Never mix different battery brands or chemistry types.
 - Always remove drained batteries immediately.
 - Remove batteries during long periods of storage.
- NOTE: Rechargeable NiCad or NiMH batteries may result in reduced brightness due to lower nominal voltage.*

Switch Operation – See Figure 2

The Fred has two light sources to choose from, 1 red Ultrabright LED or 3 white Ultrabright LEDs. Each light source has two modes (High and Low).

- To switch between the Red LED and the 3 white LEDs - Press and hold the button until the light source changes. Release the button when the appropriate source is lit. The light will remain on this LED source (allowing you to cycle through the modes) until you decide to change it.
- Modes (High and Low) are selected by pressing and releasing the button within 1.5 seconds of the previous button press. If more than two seconds has passed since the previous button press the next press will turn the light off.
- There are two ways to turn the Fred off. You can cycle through the modes until you reach off, or if the light has been on for more than two seconds the next button press will turn the light off.
- Note about changing batteries for lights with Red or Green 5mm Ultrabright: To ensure the Ultrabright LEDs turn on first, remove the old batteries, press and hold the button down for three seconds to discharge the capacitor on the circuit. Install the new batteries and close the battery door. The light will now default to the Ultrabright turning on first.

**The times listed on the rear of the package assume you have start with fresh batteries and use only one mode.

Power Consumption

Refer to the burn time chart for performance data for different battery types and mode settings.

**Princeton Tec calculates total burn time as the time it takes for the light source to produce a minimum of 0.25 lux at 2 meters. 0.25 lux is about the equivalent of a full moon on a clear night.

Figure 1 – Battery Replacement

Remplacement des piles

Einlegen der Batterien

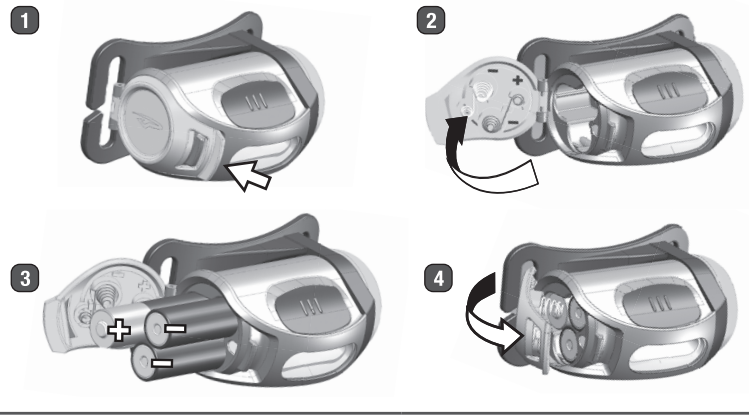
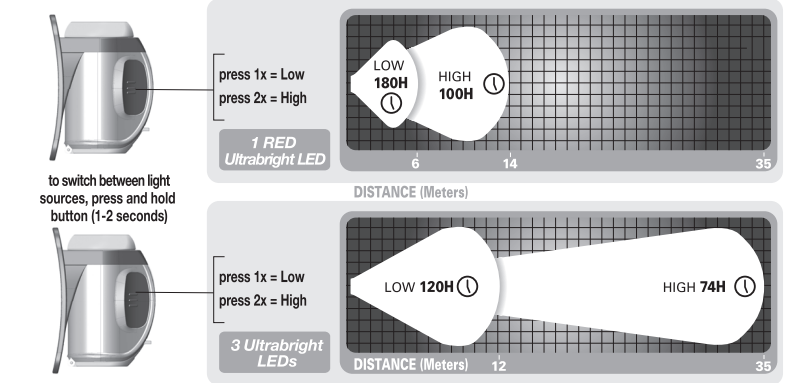

Figure 2 – Switch Operation

Modes de fonctionnement

Schalterbetätigung



- Princeton Tec calculates total burn time as the time it takes for the light source to produce a minimum of 0.25 lux at 2 meters. 0.25 lux is about the equivalent of a full moon on a clear night.
- Princeton Tec berechnet die Gesamtbranddauer bezogen auf eine von der Stirnlampe erzeugte minimale Beleuchtungsstärke von 0,25 Lux in 2 Meter Abstand. 0,25 Lux entsprechen in etwa der Beleuchtungsstärke des Vollmonds in einer klaren Nacht.
- Princeton Tec définit la durée totale d'éclairage comme le temps nécessaire à la source lumineuse pour produire un minimum de 0,25 ux à 2 mètres. 0,25 lux équivaut à peu près à l'aluminosité d'une pleine lune dans un ciel nocturne dégagé.

**The times listed in this chart assume you start with fresh batteries and use only one mode.

Troubleshooting

If the Fred fails to light:

- Check the batteries for proper installation.
- Replace batteries if proper installation is confirmed. Check circuit board for water. The light will resume normal operation once the water is shaken or blown out and the light is left open until completely dry. If the light has been contaminated with salt water, flush the unit with fresh water and dry as described above.

USA – International 5-Year Warranty

WARRANTY – Princeton Tec warrants this product to be free from defects in workmanship and materials under normal use for 5 years. This warranty covers all of the component parts of the product except batteries. This warranty does not cover deterioration due to normal wear or damage due to misuse, alteration, negligence, accidents, or unauthorized repair. Princeton Tec will repair or replace parts which are defective in workmanship or materials.

Your authorized Princeton Tec Dealer and Princeton Tec are the only facilities authorized to repair the product. After (3) unsuccessful attempts (within the warranty period) to repair the product, you have the right to elect replacement of the product or a refund of the purchase price less allowance for use of the product. NO INCIDENTAL OR CONSEQUENTIAL DAMAGES ARE INCLUDED IN THIS WARRANTY. (Some states do not allow the exclusion or limitation of incidental or consequential damages, so the above limitations or exclusions may not apply to you.) This warranty gives you specific legal rights, and you may also have other rights which vary from state to state.

Princeton Tec reserves the right to change product specifications without notice.

FOR CALIFORNIA RESIDENTS:

WARNING: This product contains Bisphenol A (BpA) a chemical known to the State of California to cause birth defects or other reproductive harm.

Return Policy

If your light fails to operate, follow these simple steps:

1. Check batteries. Replace if necessary.
2. To send your light in for repair or replacement, first contact Princeton Tec customer service on **1-800-257-9080** to request an RMA number. Please have your light model, date of purchase and a brief description of the fault you are experiencing. No warranty repairs will be accepted without an RMA number.
3. Return the light without batteries to: **Princeton Tec, PO Box 8057 Trenton NJ 08650**. Postage due and freight collect items will not be accepted.
4. Upon receipt your light will be processed in about two weeks. Please allow additional time for return transportation from NJ

Princeton Tec
PO Box 8057,
Trenton, NJ 08650
Phone: 609-298-9331
Fax: 609-298-9601
princetontec.com
© 2019 Princeton Tec



