

# USER'S MANUAL

## PHANTOM 800

BLUETOOTH® | 3" (76 mm)

WEATHER RATED BLACK SPEAKERS

**BOSS**®  
AUDIO SYSTEMS

BOSS Audio Systems  
3451 Lunar Court • Oxnard, CA 93030

[www.bossaudio.com](http://www.bossaudio.com)

800-999-1236 US Toll-free

805-751-4853 Customer Service

Tech Support: [www.bossaudio.com/support/technical-support](http://www.bossaudio.com/support/technical-support)



0119

iPod® and iPhone® are trademarks of Apple, Inc. registered in the U.S. and other countries. BOSS Audio Systems is not affiliated with Apple, Inc. The Bluetooth® word mark and logos are registered trademarks owned by Bluetooth SIG, Inc. and any use of such marks by BOSS Audio Systems is under license. Other trademarks and trade names are those of their respective owners.

# USER'S MANUAL

## PHANTOM 800

BLUETOOTH® | 3" (76 mm)

WEATHER RATED BLACK SPEAKERS

FEATURING BUILT-IN AMPLIFIER SYSTEM



**BOSS**®  
AUDIO SYSTEMS

**POWERSPORTS**

**NOTES**

**Congratulations**

**On your new purchase of a Phantom 800 off-road amplified speaker system. It has been designed, engineered and manufactured to bring you the highest level of performance and quality, for years of listening pleasure.**

**Thank you  
For making Boss Audio Systems your choice  
for motorcycle audio entertainment.**

**Please read through these instructions carefully so you will know how to operate your speaker properly. After you have finished reading this instructions, keep this document in a safe place for future reference.**

All rights reserved. No part of this publication may be reproduced, distributed, or transmitted in any form or by any means, including photocopying, recording, or other electronic or mechanical methods, without the prior written permission of BOSS AUDIO SYSTEMS.

Copyright © 2019 BOSS AUDIO SYSTEMS.

**Contents**

Phantom 800 speakers w/clamps ..... 2 pcs

Mounting inserts:

1" diameter ( installed ) ..... 4 pcs

1.25" diameter ..... 4 pcs

1.5" diameter ..... 4 pcs

5mm Hex wrench ..... 1 pc

6mm Hex wrench ..... 1 pc

**Features**

Your new Phantom 800 speakers feature the following:

- 3.5mm audio input
- Adjustable speaker clamps
- Weatherproof volume control
- Weatherproof speakers
- Bluetooth audio streaming
- Built-in class D amplifier

**Specifications**

THD: ..... < 0.1%

S / N: ..... > 75 dB

Channel separation: ..... > 50 dB

Frequency response: ..... 50Hz - 20 KHz

Input sensitivity: ..... Max 400 mv

Speaker wires: ..... 3.3'

Volume control wires: ..... 4.9'

Audio input cable: ..... 0.8'

Power cable: ..... 3.3'

Mounting diameter: ..... 1", 1.25", 1.5" only

Dimensions: HxDxW ..... 11.46" x 6.38" x 4.77"

Unit weight: ..... 5.22lbs / 2.37 kg

Specification subject to change without notice.

**Trouble shooting**

<u>SYMPTOM</u>	<u>SOLUTION</u>
No sound .....	Unit or Device is MUTED
Audio is distorted .....	Bluetooth is out of range
No Power-on tone .....	Check fuse or wiring
Bluetooth not connecting .....	Switch off power for 10 secs

*Wiring*

*Installation / Mounting*

EN

EN

QUICK USER'S GUIDE

QUICK USER'S GUIDE

1. Be sure to run the wiring securely and far away from any moving components.
2. Connect the power cable to the power source. You will need to connect the 12V red wire to a fused 5A (not included) switched power source.
3. Use the 3.5mm stereo jack to connect to your source of music (MP3 player, mobile device, etc.).
4. Use your player device and wired remote volume controller to control the volume.

1. Adjust the direction of the speaker and screw the bracket to the bottom of the speaker.
2. Select the rubber inserts that fit your mounting bar and place them into the brackets.
3. Find a safe, ideal mounting location and fit the brackets over the chosen bars.
4. Fasten the mounting screws after you review the safety of the mounting location.

*Bluetooth Connection*

*Reminder*

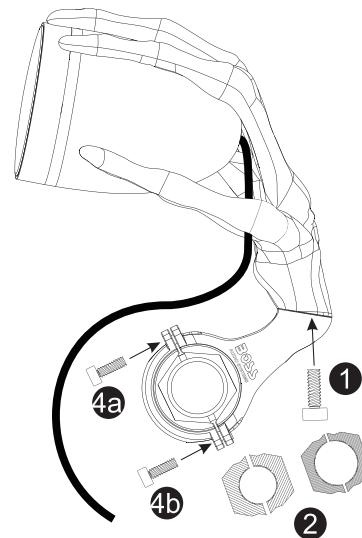
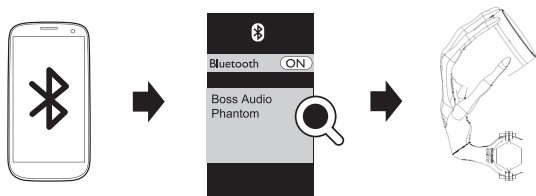

1. Go into the Settings Menu of your mobile device.
2. Enter the Bluetooth menu.
3. Search for and select “ Boss Audio Phantom ” from the available devices.
4. If prompted, enter passcode “0000”.

- The components and wiring should not be installed around any moving parts, keep away from ignition parts, fuel lines, or any hot exhaust components.
- Speakers should not be installed where they might inhibit safety features on the vehicle ( i.e. lights, horns, brake levers, etc.).

