

Route cable(s) from electronic device through the Cable Seal.

HOW DOES IT WORK?

Pass the cable through the mounting surface where waterproof point of entry is needed. The tapered rubber seal compresses around the cable(s) for a waterproof seal.

Waterproof seal between the Cable Seal and mounting surface.

No need to remove the connector due to the split seal design of the Cable Seal.

FITTING GUIDE

# OF CABLES	CONNECTOR DIAMETER	CABLE DIAMETER	SERIES
CABLE SEALS			
1 or More	Up to 0.81" (20mm)	Up to 0.53" (13.5mm)	CG20 SERIES
1	Up to 0.81" (20mm)	Up to 0.53" (13.5mm)	CG2090
1 or More	Up to 1.38" (34mm)	Up to 1.08" (27.5mm)	CG30 SERIES
Multiple	Up to 0.67" (17mm)	Up to 0.50" (10.6mm)	CGM17 SERIES

RETROFIT CABLE SEALS			
1	Up to 0.81" (20mm)	Up to 0.53" (13.5mm)	CG20PG2
1 or More	Up to 1.38" (34mm)	Up to 1.08" (27.5mm)	CG30PG2

APPLICATIONS

MARINE

- Radars, Sat TV, Cameras, Lights, Antennas, Solar, etc.

AUTO / RV / VAN CONVERSIONS

- Lights, solar panels, Sat TV, antennas, etc.

HOME / INDUSTRIAL

- Paintable outer housings to match house/ building
- Solar panels, lights, antennas, cable, etc.

MISC

- Any application that requires water tight cable entry



Seaview Cable Seals can be used for many applications. The example shown is our Cable Seals used for solar panels on top of wind turbines



Seaview Cable Seal installed on the roof of a Van for solar panels.

SEAVIEW
2225 N. Molter Rd.
STE 105
LIBERTY LAKE, WA 99019
(800) 655-7922
info@seaviewglobal.com



SEAVIEW

CABLE SEALS

Waterproof Cable Routing



WWW.SEAVIEWGLOBAL.COM

THE SEAVIEW/// CABLE SEAL

The Seaview Cable Seal (also known as CableClams or Deck Seals) provide waterproof cable routing. Made of very strong UV resistant plastic or marine grade 316 stainless steel that come in a variety of colors and finishes (black, white, gray & polished S.S.). Seaview cable seals fit a wide range of cables and connectors.

All Seaview cable seals will work with more than one cable as long as each cable has its own hole and there is at least .125" (31mm) of rubber around each hole.

IPX6 & IPX7 Tested & Approved. What does this mean?

- IPX6 test means these pass 100L/min of water sprayed from 2.5 to 3 meters away for 3 min
- IPX7 test means these pass a 30 minute submersion under 1 meter of water

IMPROVED DESIGN

Unlike other brands, our inner rubber seal is flush with the top of the cable seal so that so that water, dirt, grime, etc. does not have a place to collect.

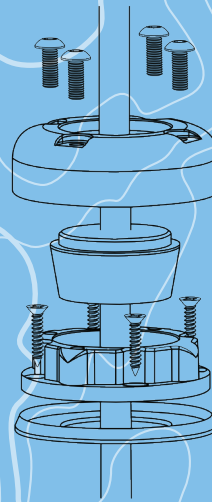
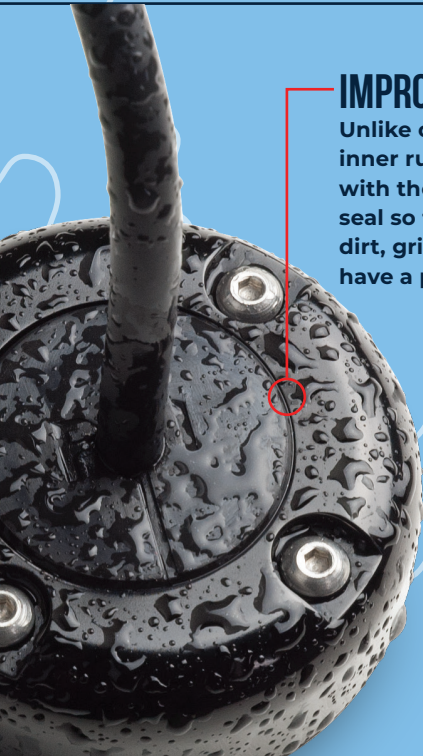

CABLE SEALS WATERPROOF VERTICAL CABLE ENTRY

- Made of very strong UV resistant plastic or marine grade 316 stainless steel that come in a variety of colors and finishes
- All Seaview cable seals will work with more than one cable

RETROFIT CABLE SEALS WATERPROOF VERTICAL CABLE ENTRY

- The only guaranteed and proven waterproof installation for your previously installed cables
- No need to re-run your cables, simply install with your cable in place
- Made of very strong UV resistant plastic to fit a wide range of cable sizes

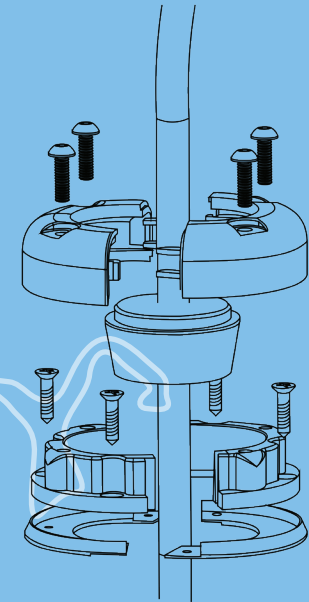

90 DEGREE CABLE SEAL WATERPROOF HORIZONTAL CABLE ENTRY

- For cables up to 1/2" in diameter, ideal for almost any installation
- Perfect for rooftop electronics such as solar panels, light bars, lights, etc.
- Available in black UV stable high-impact plastic

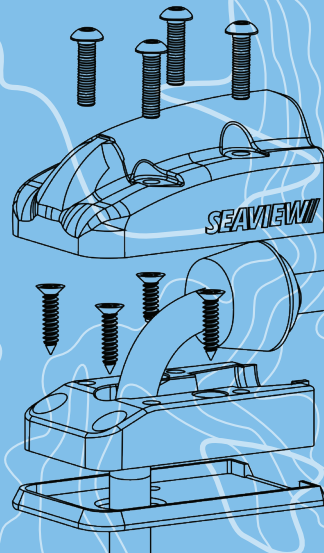

Drill Tubes Included!

Each cable seal comes with 4 brass drill tubes (6, 8, 10 & 12mm). These are used to drill very clean and easy holes vs a typical drill bit. Some other brands do come with pre-drilled rubbers but we choose to include metal drill tubes that can be recycled or reused when finished vs the extra rubber pieces that will end up in the landfill from others!